

## Precautions & Warnings!

- Read all instructions carefully, the safety of this product is only guaranteed if the instructions are followed, retain these instructions for future use
- Turn Off the power supply before installation and maintenance
- Installation must be done by trained professional and in accordance with National electrical code & regulations.
- To avoid the risk of fire and overheating, make sure all connections are made properly.
- Don't pinch or apply excessive tension on electrical wires. Damages due to improper handling and installation will void the warranty.

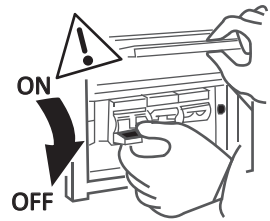

**Shock  
Hazard**



## Luminaire Details

Power Supply	220-240V AC
Engine IP Rating:	IP 54
Driver IP Rating:	IP 20
Class:	
T <sub>a</sub> Max:	40°C

Fixing Method:	Push in
Bezel Size:	100x100 mm
Recessed depth:	125 mm
Ceiling cut-out:	100x100 mm
Ceiling thickness Range:	1-25 mm

## Tools For Installation

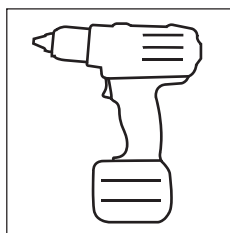

Drill

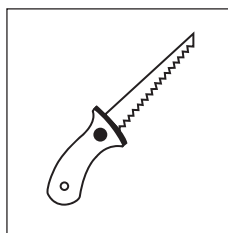

Saw

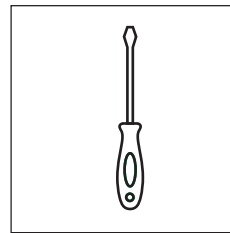

Screw Driver

- 1** Make 100x100mm cut-out for luminaire by using saw

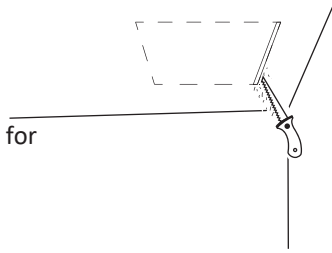

- 6** Pull the mains power supply/dimming cable out from the cut-out to make necessary connections with driver as per wiring diagram on page 3

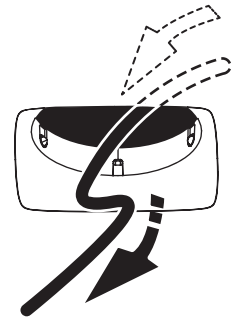

- 2** Wear gloves while handling the luminaire and avoid contact with reflector and lens

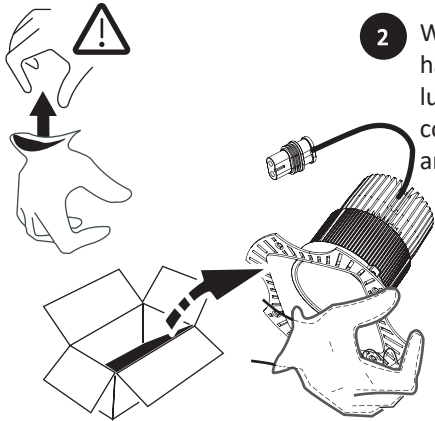

- 7** Pass the driver through the cut-out and leave the low voltage connector protruding through the hole

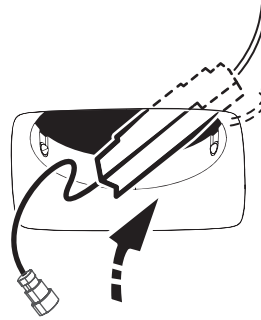

- 3** Hold the bezel and gently rotate the heatsink until the pips are aligned with the grooves, then push the bezel in an upward direction as shown until it snaps out from the main body

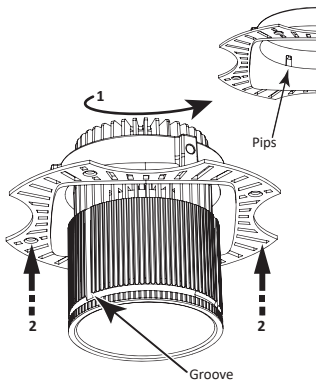

- 8** Plug in the female connector of driver into the male connector of luminaire

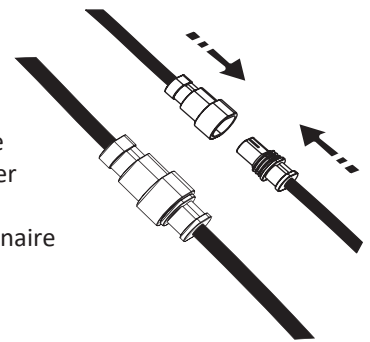

- 4** Place the bezel into the cut-out and fix it on the ceiling using screws

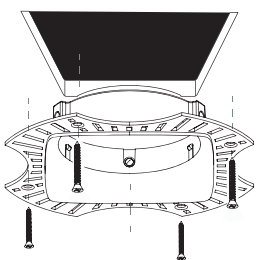

- 9** Make sure to leave a minimum gap of 100 mm between luminaire and any insulation

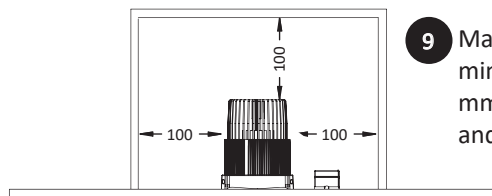

- 5** Apply POP/plaster to cover the bezel. Make sure to keep the internal area clean

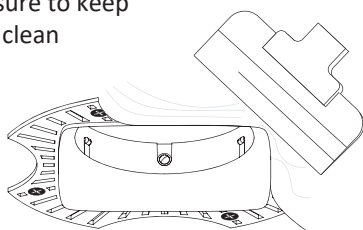

- 10** Align the pips of the main body with the grooves of the bezel and push the main body into the bezel till it snaps into position

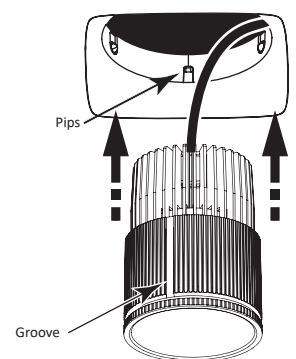

- 11** Turn on Power Supply

• Wiring Diagram for Non Dimmable Driver

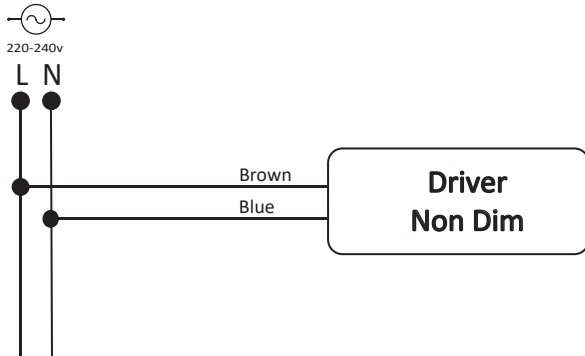

• Wiring Diagram for Phase Cut Driver

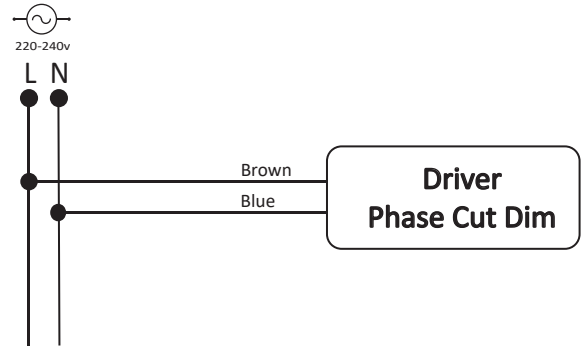

• Wiring Diagram for Dali dimming Driver

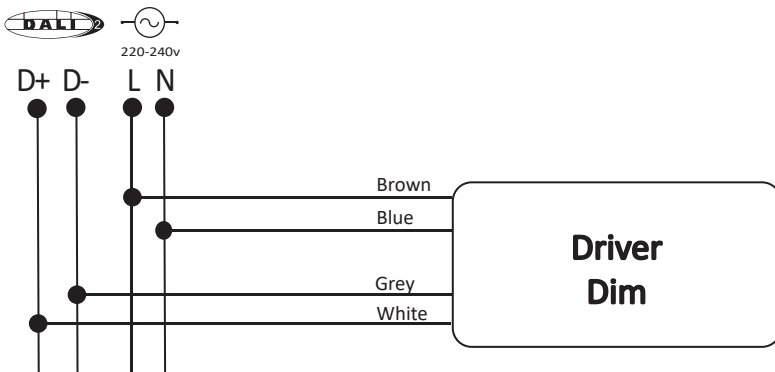

• Product Dimension's

