

SPT 40/60/90

INSTALLATION/MAINTENANCE INSTRUCTIONS - SUSPENDED

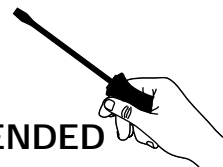

LIGHT FORMS

TOOLS REQUIRED

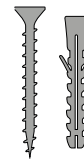
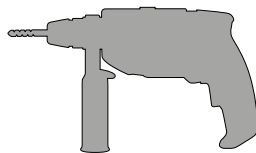

CAUTION! Make sure that the luminaire is always disconnected from mains during installation or maintenance work.

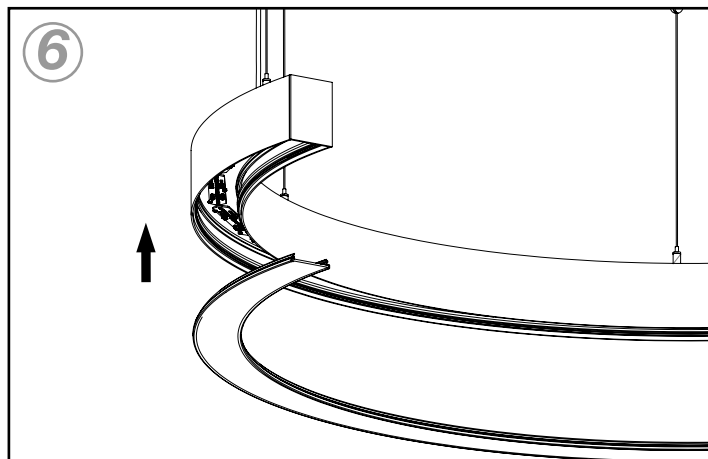
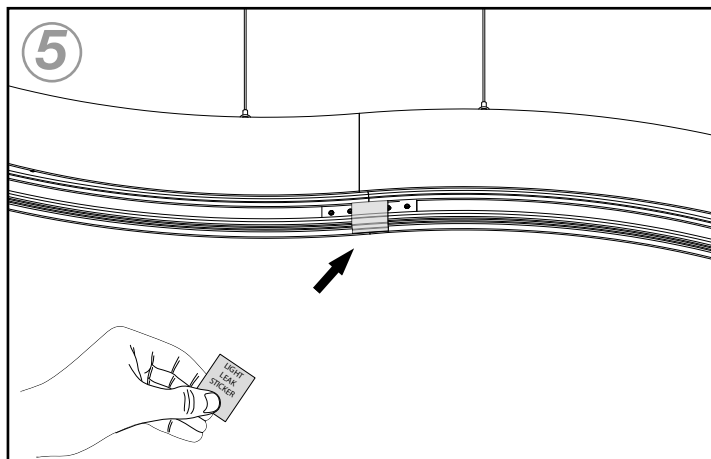
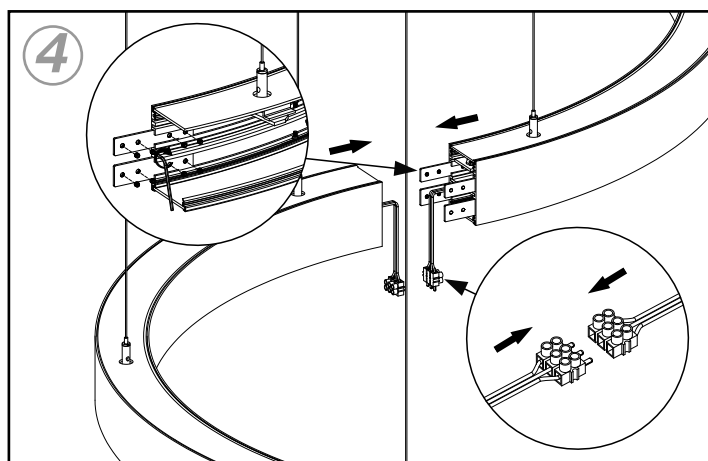
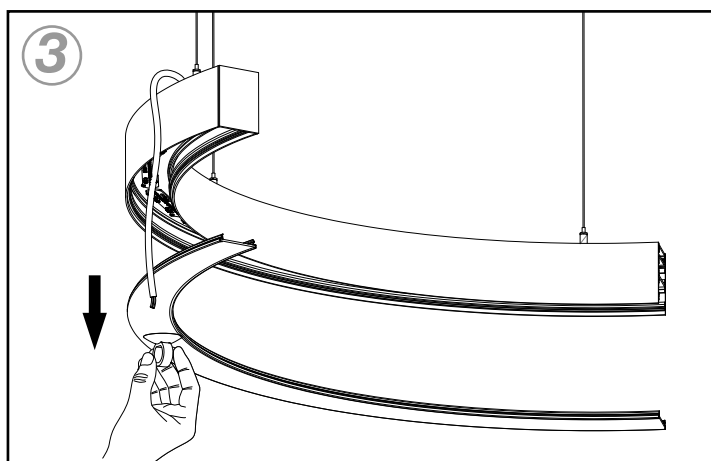
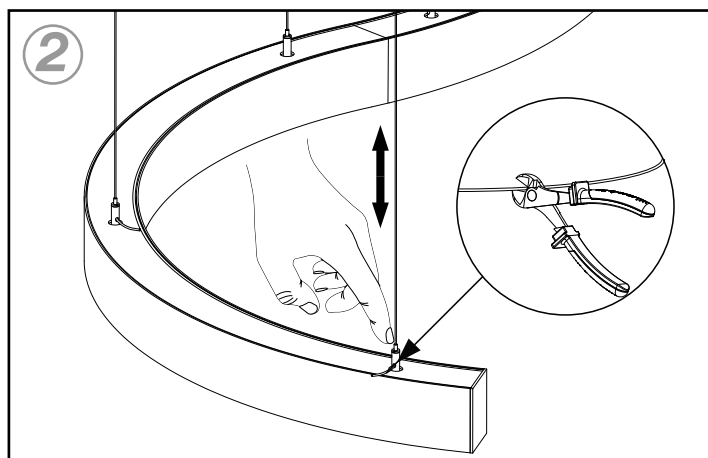
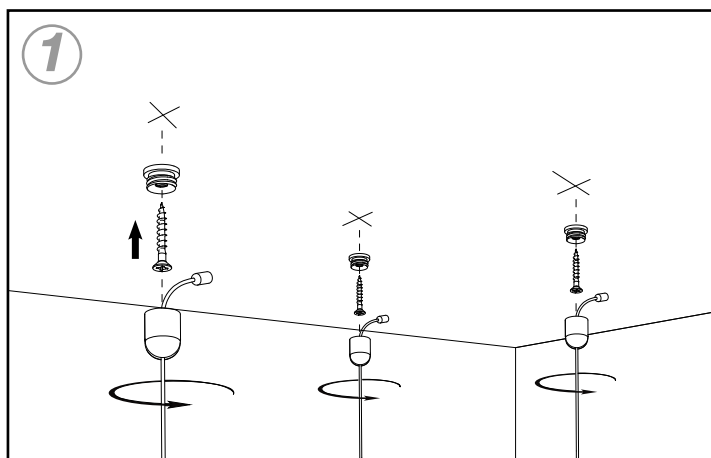

SPT 40/60/90

INSTALLATION/MAINTENANCE INSTRUCTIONS - SUSPENDED

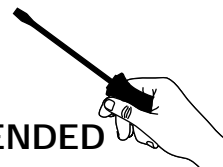

LIGHT FORMS

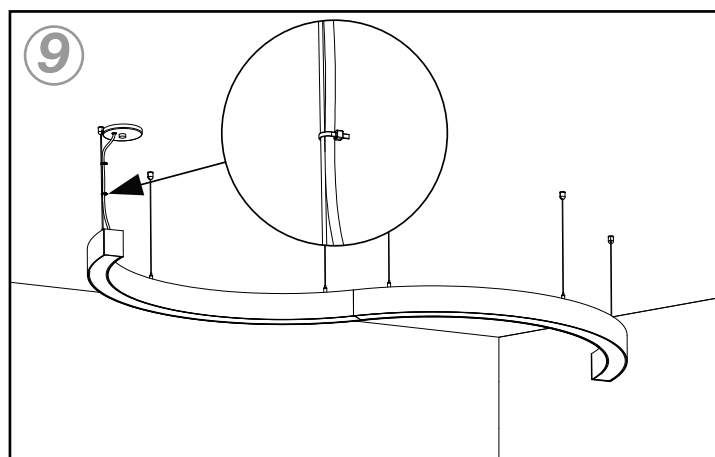
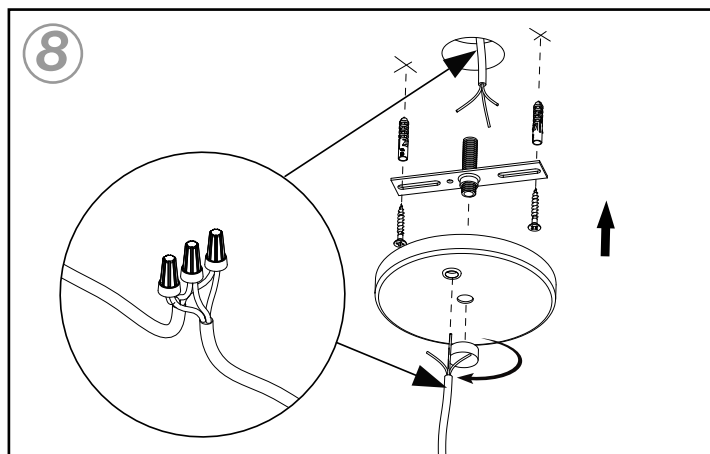
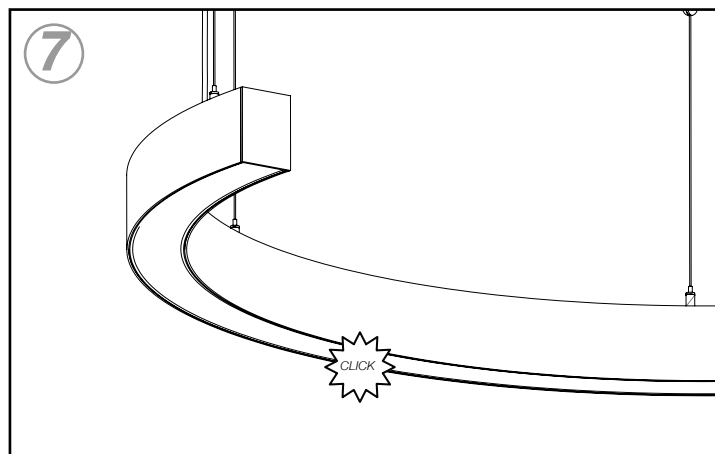

Wiring Diagrams

Non Dimmable (ON/OFF)

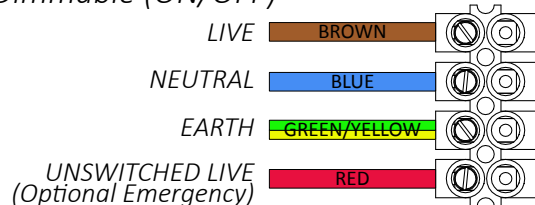

Switch Dimming

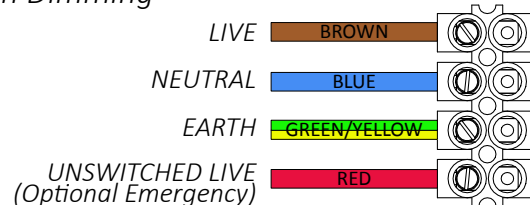

DALI Dimming

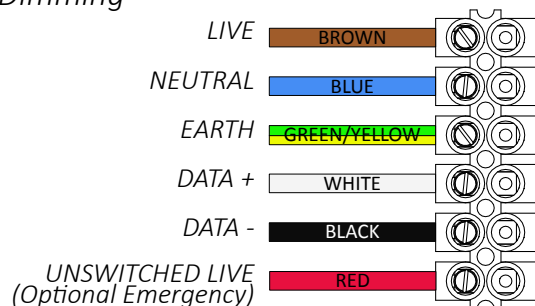

1-10V Dimming

